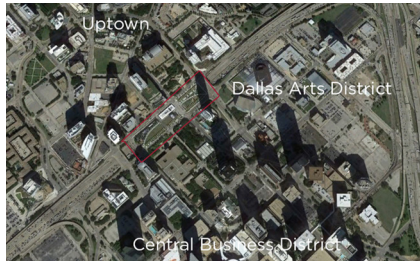

IMAGE CAPTIONS LIST



FILE NAME KlydeWarrenPark_Dallas_001
 CAPTION Klyde Warren Park is located at 2012 Woodall Rodgers Freeway in Dallas, Texas and decks over the sunken Woodall Rodgers Freeway, which had previously been an imposing barrier between downtown and the densely populated Uptown neighborhood.

PHOTO CREDIT Google Earth



FILE NAME KlydeWarrenPark_Dallas_002
 CAPTION Built over an existing freeway, Klyde Warren Park provides a variety of flexible outdoor rooms that support a diverse range of free programmed activities. Since opening in October 2012, the park has been enthusiastically adopted by the citizens of Dallas.

PHOTO CREDIT Aerial Photography, Inc.

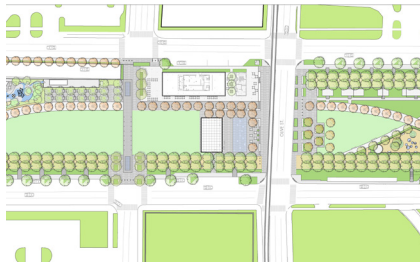

FILE NAME KlydeWarrenPark_Dallas_003
 CAPTION The 5.2-acre park has 13 programmed spaces that are laid out along the central pedestrian promenade.

PHOTO CREDIT The Landscape Architect



FILE NAME KlydeWarrenPark_Dallas_004
 CAPTION The park has numerous environmental benefits, including the sequestration of an estimated 18,500 pounds of carbon annually, interception of 64,000 gallons of stormwater runoff and a marked reduction in temperature, air pollution and noise.

PHOTO CREDIT Thomas McConnell



FILE NAME KlydeWarrenPark_Dallas_005
 CAPTION Central to the design of the children's park is the butterfly fountain, whose programmed jets emulate a wriggling caterpillar whose "transformation" into a butterfly is marked by a burst of water and mist. Rolling berms wrapped with artificial turf under a canopy of River Birch create a fun and safe environment for children to play and socialize.

PHOTO CREDIT Dillon Diers Photography



FILE NAME KlydeWarrenPark_Dallas_006
 CAPTION Food trucks - which were originally temporary food options while the restaurant was under construction - have become so popular that they have become a permanent feature. Groves of trees help buffer the park from the busy city streets.

PHOTO CREDIT Gary Zvonkovic



FILE NAME KlydeWarrenPark_Dallas_007
 CAPTION The park's reading and games room is monitored by docents who manage the collector of chess, checkers, and other board games available for free to use by the public.

PHOTO CREDIT Serkan Zanagar



FILE NAME KlydeWarrenPark_Dallas_008
 CAPTION The heart of Klyde Warren Park is a 40,000 square foot great lawn with a performance pavilion designed to accommodate a full symphony orchestra.

PHOTO CREDIT Courtesy The Dallas Opera



FILE NAME KlydeWarrenPark_Dallas_009
 CAPTION The Botanical Garden offers an ever-changing sensory experience for garden lovers with a variety of native and adapted plant material in exciting compositions of form, color and texture.

PHOTO CREDIT Dillon Diers Photography



FILE NAME KlydeWarrenPark_Dallas_010
 CAPTION Klyde Warren Park hosts an average of five free activities each day, including musical performances, fitness activities, book readings, arts and crafts, pet events and seasonal activities.

PHOTO CREDIT Dillon Diers Photography